



FGG22805

## 12Volt 28Ah

### Specifications

Nominal Voltage(V) 12V

#### Nominal Capacity

20 hour rate	(1.4A	to	10.50V)	28Ah
5 hour rate	(4.76A	to	10.20V)	23.8Ah
1 hour rate	(15.4A	to	9.60V)	15.4Ah
3 C	(28A	to	9.60V)	14.93Ah

Weight Approx. 9.5kg(20.9Lbs.)

Internal Resistance (at 1KHz) Approx. 8 mΩ

#### Maximum Discharge Current for

5 seconds: 420A

#### Charging Methods at 25 (77 )

##### Cycle use:

Charging Voltage 13.8 to 14.4V

Coefficient -5.0mv/ /cell

Maximum Charging Current : 8.4A

##### Standby use:

Float Charging Voltage 13.50 to 13.80V

Coefficient -3.0mv/ /cell

#### Operating Temperature Range

Charge -15 (5 ) to 40 (104 )

Discharge -15 (5 ) to 50 (122 )

Storage -15 (5 ) to 40 (104 )

#### Charge Retention (shelf life) at 20 (68 )

1 month 92%

3 month 90%

6 month 80%

Case Material ABS

(UL94 HB flame retardant )

Terminal F6

#### Description of torque value of hard ware for the terminals:

Recommended torque value M5: 2.94 N-m (30kg-cm)

Maximum allowable torque value M5: 4.90 N-m (50kg-cm)



### Dimensions

mm(inch)

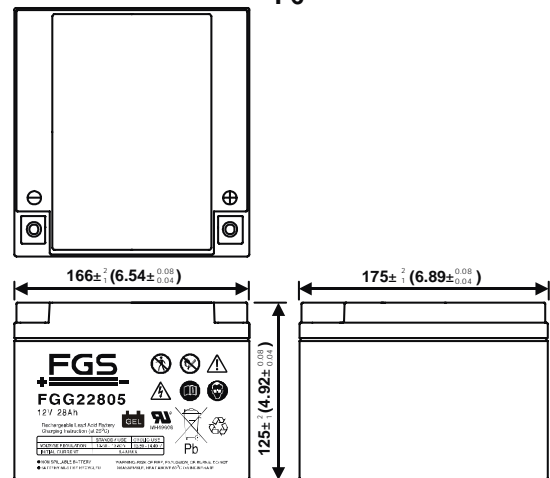
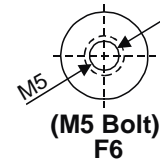

#### Discharge Time VS. Discharge Current (25 )

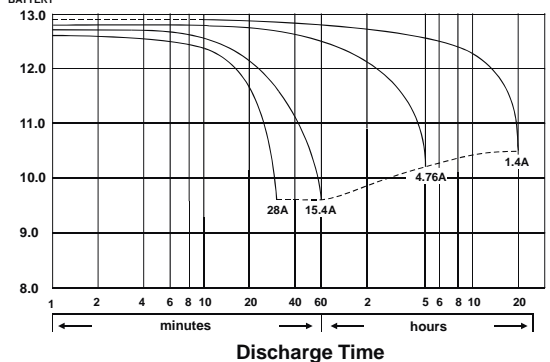

**Effect of Temperature on Capacity 25 (77 )**

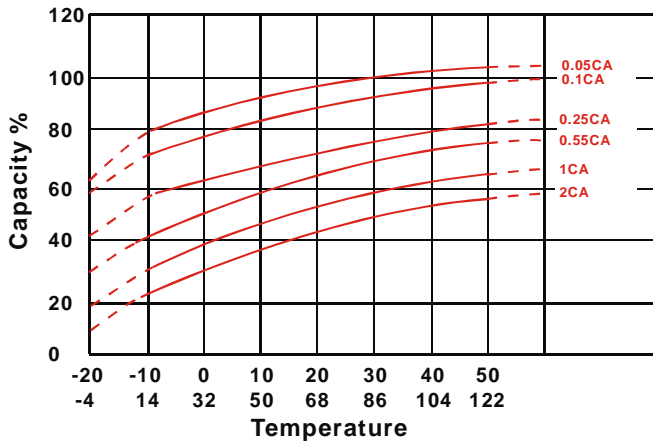

**Capacity Retention Characteristic**

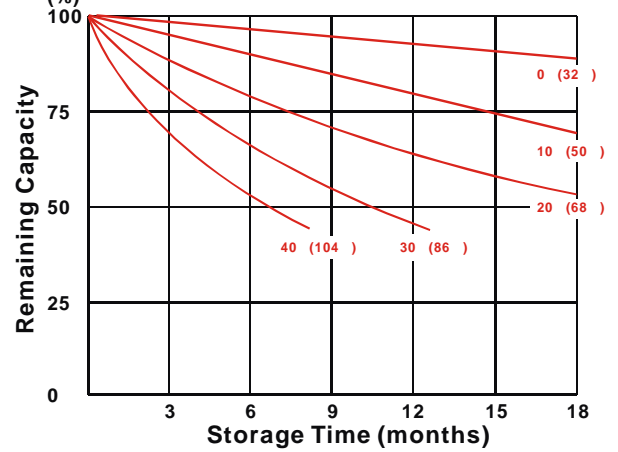

**Trickle (or float) Service Life**

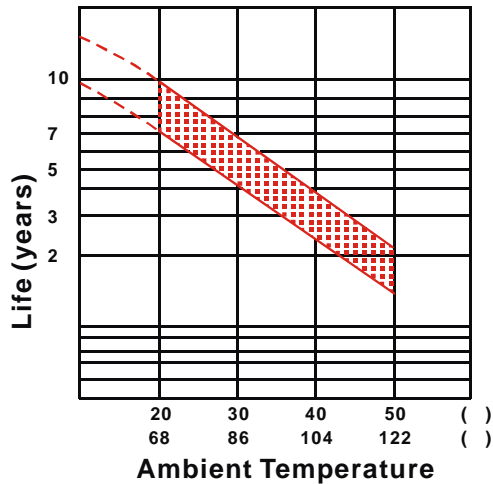

**Cycle Service Life**

